

Simple/Reliable/Green/Efficient

大牧人
Big Herdsman

POULTRY DRINKING LINES

Nipple-style watering system with a simple, reliable structure and excellent water supply and sealing performance.



WEBSITE

✉ bigherdsman@bigherdsman.com



POULTRY PRODUCTION

Technical Description

- Two-stage filtration at the front end removes impurities from the water.
- A separate back-flush pipeline can precisely record birds' water consumption.
- Special pressure regulator adjusts water pressure and flow rate to meet drinking requirements at different ages; equipped with a manual/auto back-flush knob for line cleaning.
- Double-seal nipple allows 360° side triggering and top triggering, ensuring birds can drink from any angle.
- The water pipe uses expandable male-female joints to compensate for thermal expansion and avoid damage.
- Transparent hose and centralized drain line at the end for easy observation and flushing.
- Red or yellow nipples are available for breeders or broilers, with adjustable water flow depending on pressure and day age.

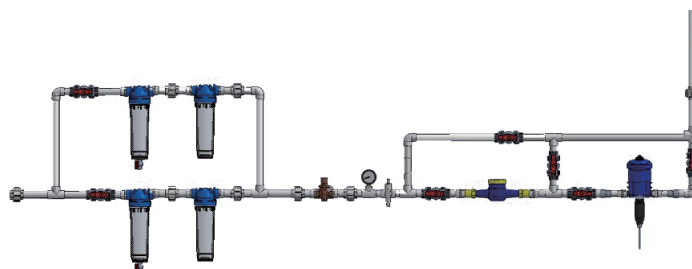

- There are two kinds of drinking nipples (red and yellow) for feeding breeders and broilers respectively. Water can come out from the upper top by laterally tapping in any direction within 360°. Its water flow can be adjusted according to water pressure to meet the drinking demands of the poultry of different ages in days.

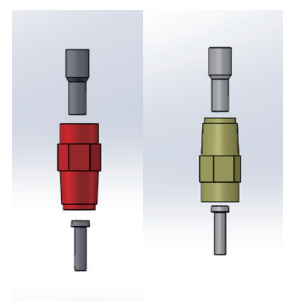

Technical Parameters

S/N	Category	Feeding capacity
1	Broiler	8-12birds/Unit
2	Duck	10birds/Unit
3	Breeder	10birds/Unit

DRINKING NIPPLE FEEDING CAPACITY

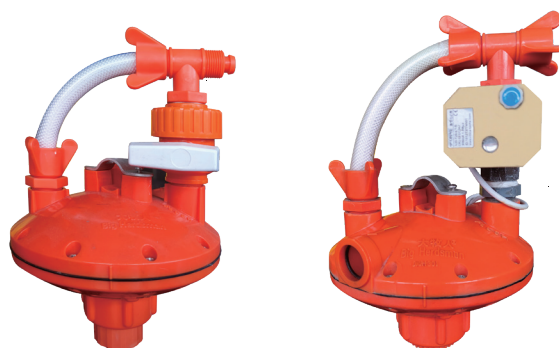

QINGDAO BIG HERDSMAN MACHINERY CO.,LTD

Add: Yuehe road, Konggang industrial park, Qingdao city,
Shandong Province, PR China
Tel: +86-532-8493 3988
Website: www.bigherdsman.com



SCAN QR CODE ON WECHAT

Simple/Reliable/Green/Efficient

大牧人
Big Herdsman

POULTRY ROUND-PIPE DRINKING LINE

Provides stable water flow and efficient filtration, offering a long service life.



WEBSITE

✉ bigherdsman@bigherdsman.com



POULTRY PRODUCTION

Technical Description

- Two-stage filtration at the front end effectively removes impurities.
- Made of highly durable materials that resist deformation and withstand pressure.
- Integrated ball-valve drinkers with stable flow rates, no drips or leaks.
- A well-designed one-piece structure prevents pipe rotation issues.

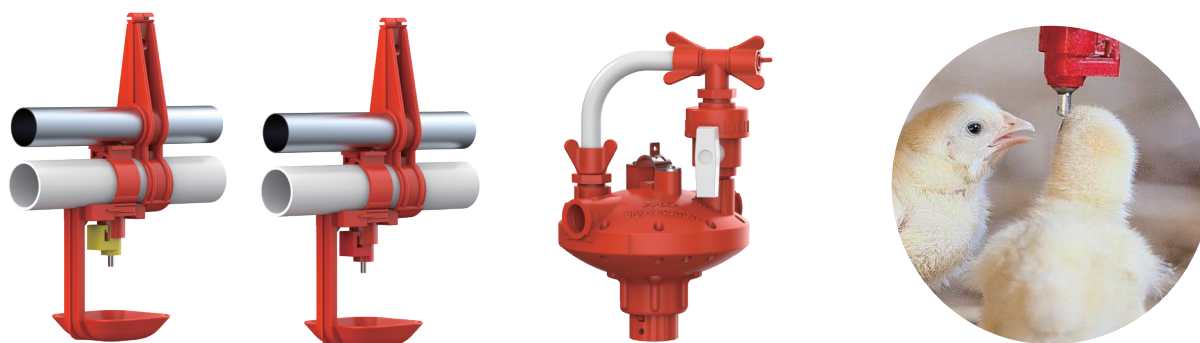

Parameter

Product name	Round tube waterline for chickens
Structural form	Integral ball valve drinking water, 360° side impact can water
Ball valve drinking water equipment quality	ABS polypropylene and 304Stainless steel
Applicable water pressure	2kpa~6kpa 2kpa~6kpa
Outer diameter of the main water inlet pipe	Equal to or greater than 32mm
External dimensions of drinking pipe	Φ33.4 Φ33.4

QINGDAO BIG HERDSMAN MACHINERY CO.,LTD

Add: Yuehe road, Konggang industrial park, Qingdao city,
Shandong Province, PR China

Tel: +86-532-8493 3988

Website: www.bigherdsman.com



SCAN QR CODE ON WECHAT