

Simple/Reliable/Green/Efficient

大牧人
Big Herdsman

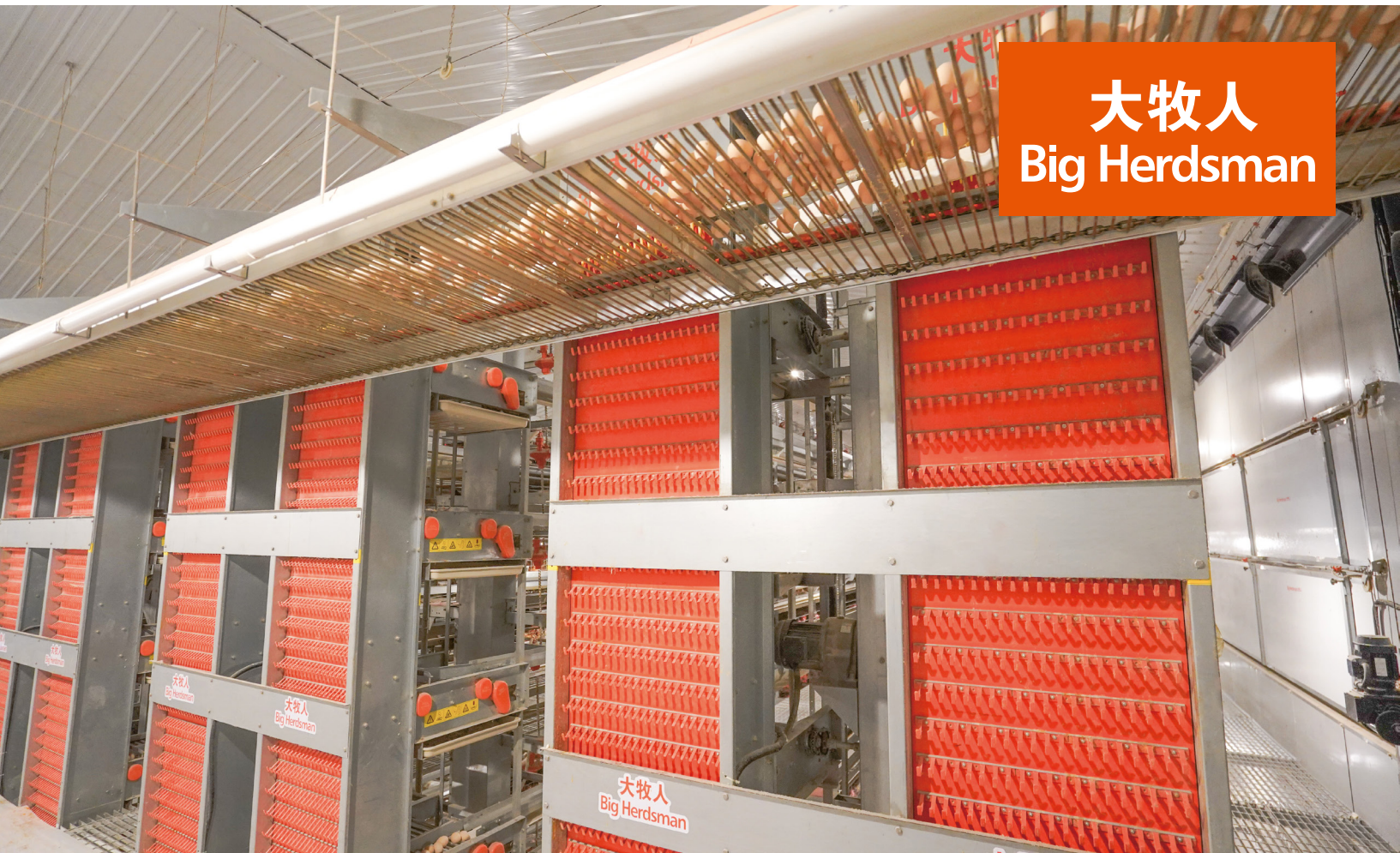

EGGS COLLECTION SYSTEM

Big Herdsman's egg collection system includes a variety of functional modules such as egg buffering devices, egg collection belts, sprocket boxes, elevator collection systems, manual collection tables, and more. This system provides efficient, reliable, and low-breakage solutions tailored to diverse customer needs.



WEBSITE

✉ bigherdsman@bigherdsman.com



EGG PRODUCTION

EGG COLLECTION SYSTEM

Central Egg Collection Part

Big Herdsman central egg collection part is designed according to the customer's poultry house and terrain so that it can meet various needs for egg collection in cages. Characterized by modular unit design, convenient installation and maintenance, stable and reliable operation, low noise level, and low egg breaking rate, the part can be linked with the in-house egg collection system remotely. In the egg storage, egg packaging equipment can be selected, and an egg collecting table can also be set up for manually picking eggs in order to meet the customer's needs for egg collection.

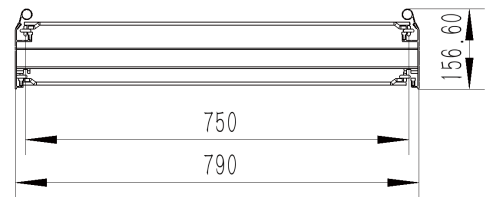

- Conveying speed: about 6.5 m/min;
- Maximum conveying quantity: 65000 eggs/h;
- Motor: 380 V, 50 Hz, 0.37 kW, $i=80.65:1$ (motor with different parameters customizable according to the customer's needs);
- Conveying chain: 750 center distance, made of premium galvanized manganese steel, high-strength and anti-corrosion;
- Drive: self-contained chain tensioner to ensure the smooth operation;
- Outer frame: The outer frame made of aluminum, beautiful, corrosion-resistant, and not easy to rust;
- Guide rail: It is made of wear-resistant plastic and suffers small self-lubricating resistance. Its chain runs smoothly;
- Slope adjustment: freely adjustable within $0-20^\circ$ to adapt to various terrains to the greatest extent;
- Turning: smooth transition at turning, customizable angles;
- Lubrication: The oil dripper is automatically controlled to add lubricating oil to make sure that the system operates stably;
- Spare parts: Supporting spare parts include the control power box, indoor and outdoor support, egg guide plate, rain cover, and cables.

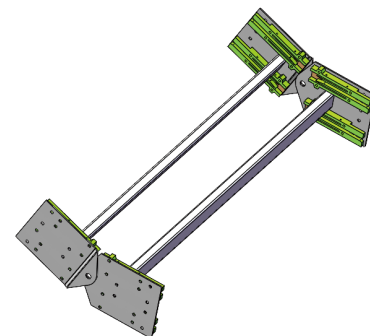
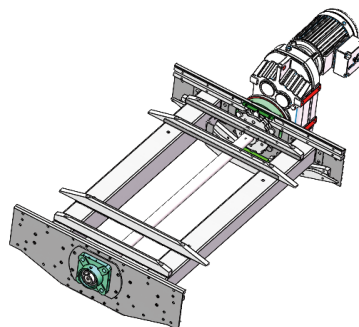
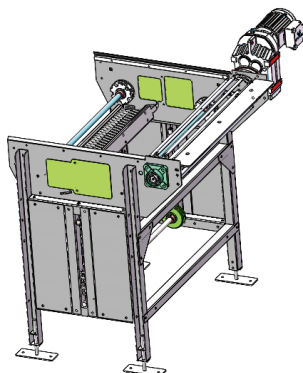
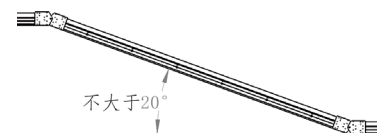
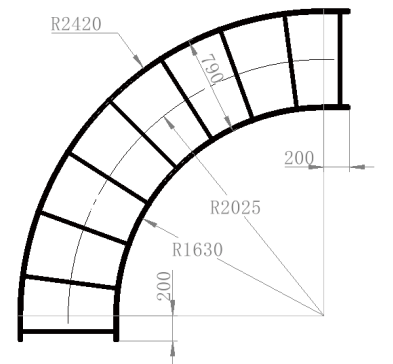

EGG COLLECTION SYSTEM

Elavator Egg Collection Part

- Widths can be customized to meet the needs for egg collection in various cage types;
- Motor power: 0.2 kW/0.4 kW, operating speed: about 3.3 m/min;
- 2 mm PVC conveyor belt, which looks gorgeous and durable;
- Egg claws are made of nylon + glass fiber by injection molding, and are featured with high strength, excellent toughness, corrosion resistance, and aging resistance;
- The egg collection claw belt is riveted and solidified by a middle metallic plate, to ensure that the belt is stable and regular;
- Strong egg collection capacity; maximum egg collection quantity in a single row: 1.8w eggs/(hour*row) (regularly 1-1.2w);
- There are anti-deviation adjustment at both the top and bottom. Manual adjustments can be made to prevent the belt from deviating so as to avoid unnecessary damage to the conveyor belt.

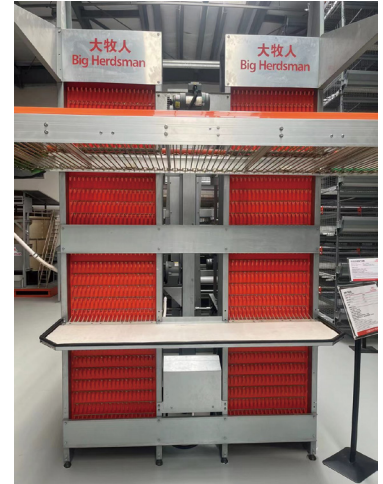

Longitudinal Egg Collection Part

- Motor power: 0.4 kW; various egg collection methods can be selected according tiers;
- The egg shaft, belt roller, and brush are all equipped with bearings to ensure smooth running without noise;
- The end rotating wheel with tensioning mechanism, which allows the adjustments on tensioning and deviation of the egg collecting belt;
- At the bottom of the cross egg collection part at each tier, there is a collecting pan to collect soft and broken eggs, dust, etc.
- The egg collecting pipe is made of premium aluminum alloy to ensure that the pipe is strong enough and can effectively filter soft and broken eggs;
- The egg collecting guide device functions to ensure that eggs are evenly distributed into the elavator (egg)collection parts, reducing the risk of egg collision and improving the egg collecting efficiency;
- Brushes are provided at the bottom of the egg belt roller and the end egg collecting belt. They are used to collect dust, feathers and other sundries from the egg collecting belt;
- The sprocket box is closed structure so as to ensure, prevent the sprocket drive from hurting personnel and birds, and make sure that the sprocket chain is dust-free.



Manual Egg Collecting Table

- Used for manual egg collecting at the front end of poultry house, firm and durable, height adjustable;
- PVC belt and EPDM foaming structure on edges, effective buffer, reduce the rate of broken eggs.



Egg Buffer

- The number of lifting times and lifting frequency can be adjusted based on actual needs;
- The push rod motor provides lifting power, so there is no need for additional air source, etc.;
- The moisture of the fresh egg shell evaporates on the bottom mesh to reduce dust and feathers attached to the egg shell surface;
- Eggs roll smoothly into the egg collecting belt to reduce collision on the egg collecting belt, reduce egg breaking rate.

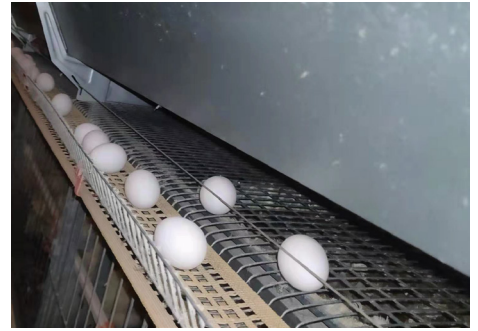

Egg Puller

- Premium rubber egg claws, flexible, no damage to eggs;
- PP egg scraper with exact dimensions, low impact;
- Fixed interval for egg scraper and egg puller, so as to effectively reduce the risk of mutual egg collision when directly rolling into the central egg collection part and reduce the egg breaking rate.



Egg Collecting Belt

- Width of egg collecting belt: 95 mm;
- The egg collecting belt is washable, antibacterial, antistatic, and dust-free;
- Speed of egg collecting belt: 1.7 m/min. The speed can be changed according to actual needs or adjusted by an optional variable frequency motor.



- Solid: pp material, with low elongation. After it has been installed for the first time, there is no further need to cut and stitch it again.

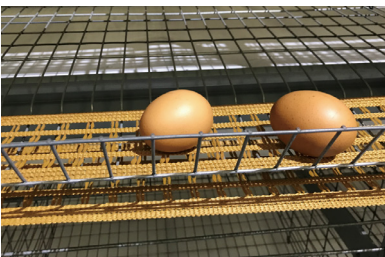

- Holed: polyester material, has a larger elongation than the solid egg collecting belt. After a period of use, the belt has to be cut short and stitched again. If egg is broken, the egg liquid can flow into the feed trough below the belt through these holes to reduce effect.



BIG HERDSMAN MACHINERY(JIAOZHOU) CO.,LTD

Add: Shangde Avenue and Huanghe Road Intersection, Jiaozhou Economic and Technological Development Zone, Qingdao City, Shandong Province, China
Tel: +86-532-6696 2297 / +86-532-5850 3988
Website: www.bigherdsman.com



SCAN QR CODE ON WECHAT